

# VERDE LUCE

DESIGN RENZO SERAFINI

10.041



IP20

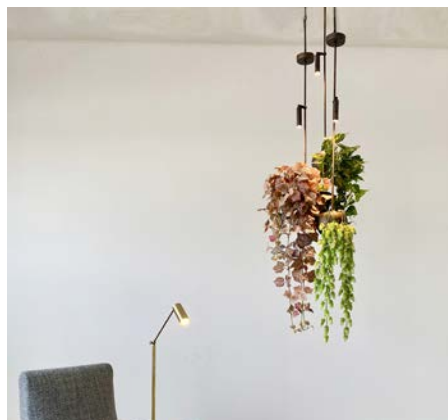

**lampada sospesa con 2 forme di fioriera diam.300 o diam.160 (ghianda) in alluminio e ferro in finitura oro materico, cilindretto orientabile con LED incluso, asta rigida di varie misure**

pendant lamp/ 2 different planter diam.300 or diam.160 (ghianda) aluminium and iron, material gold finish, adjustable small cylinder, LED included, different size rigid rod

**ATTACCO • LAMP HOLDER**

LED

**tensione di alimentazione • supply voltage** 350mA

**SORGENTE LUMINOSA • LIGHT SOURCE**

**potenza • power**

3 W

**lumen • lumen**

400 lm

**temperatura colore • colour temperature**

2700 K

**\*LED integrato • \*built in LED**

**CARATTERISTICHE FISICHE •**

PHYSICAL CHARACTERISTICS

**materiale • material**

alluminio, ferro / aluminum, iron

**finitura • finish**

oro materico / material gold

**Classe Energetica / Energy Label** G

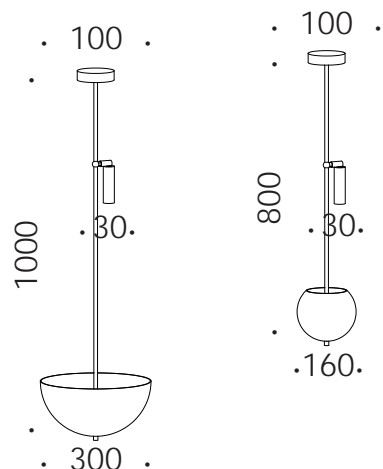

# VERDE LUCE

## istruzioni di montaggio • assembly instruction

[disattivare l'alimentazione di rete prima di iniziare l'installazione]  
[switch off the mains supply before starting the installation]

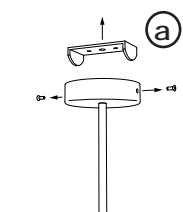
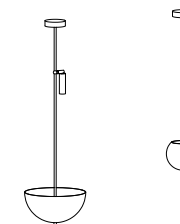

- 1 **svitare le viti e fissare a soffitto la base 'a'**  
undo the screws and fix the base 'a' to the ceiling



- 5 **Alimentare con 230V**  
Power with 230V

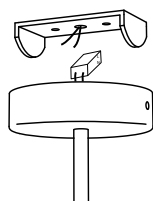

- 2 **eseguire il cablaggio alimentando con 230V il morsetto L/N in uscita dal trasformatore**  
do the wiring powering with 230V the L/N transformer terminal output

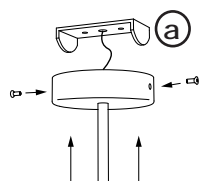

- 3 **Fissare la struttura alla base 'a'.**  
Fix the structure to the base 'a'.

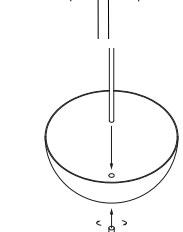

- 4 **Avvitare il cestello all'asta verticale e fissarlo tramite la piccola boccola terminale ruotandola**  
Screw the basket to the vertical rod and fix it by turning the small terminal bush