

DESIGN RENZO SERAFINI

# Mexical

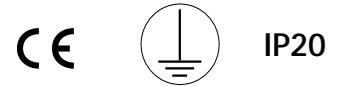

**DESCRIZIONE DESCRIPTION**

**piatto in ferro**  
**diametro 250/400**  
**con bordo, cavo**  
**alimentazione in**  
**tessuto cotone,**  
**base di fissaggio**  
 iron plate diameter  
 250/400 with  
 board, electric wire  
 covered, ceiling  
 base

**\*lampadina non inclusa**  
 \*bulb not included

**LAMPADA/ATTACCO**  
**LAMP/LAMP HOLDER**

E27 230V

**diametro 400**  
 diameter 400

**COD.** ART.10.016.3

**COD.** ART.10.016.6

**FINITURA** ferro nero / black iron

**FINITURA** corten / corten

**MATERIALE** ferro / iron

**MATERIALE** ferro / iron

**diametro 250**  
 diameter 250

**COD.** ART.10.008.3

**COD.** ART.10.008.6

**FINITURA** ferro nero / black iron

**FINITURA** ferro nero / black iron

**MATERIALE** ferro / iron

**MATERIALE** ferro / iron

DESIGN RENZO SERAFINI

# Mexical

## ISTRUZIONI DI MONTAGGIO

### ASSEMBLY INSTRUCTION

[disattivare l'alimentazione di rete prima di iniziare l'installazione]  
[switch off the mains supply before starting the installation]

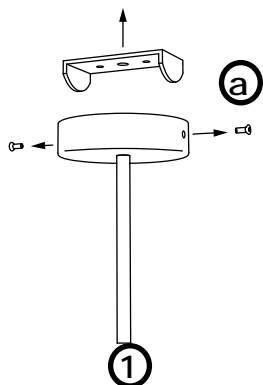

**svitare le viti e fissare a soffitto la staffa 'a'**  
undo the screws and fix 'a' to the ceiling

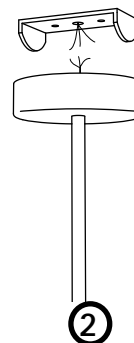

**eseguire il cablaggio alimentando con 230V.**  
**Collegare cavo giallo/verde di messa a terra**  
do the wiring with 230V power supply.  
Connect the yellow/green ground wire

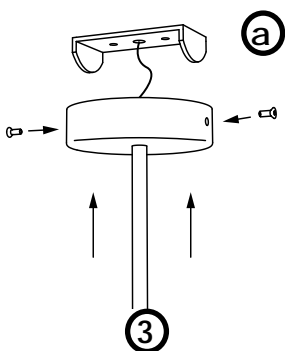

**fissare la struttura ad 'a' ed avvitare le viti laterali**  
fix the structure to 'a' and tighten the side screws

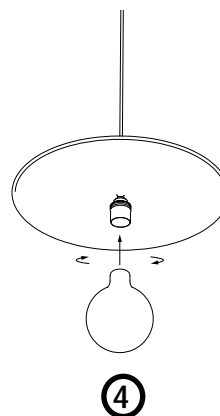

**avvitare la lampadina al portalampada E27**  
screw the bulb to the E27 lampholder

*Renzo Serafini*