

DESIGN RENZO SERAFINI

Isolatore 250



IP20



DESCRIZIONE DESCRIPTION

corpo in ferro in acidatura scura, diametro 250 mm, particolari in ottone naturale, cavo alimentazione in tessuto cotone, **basetta di fissaggio con driver**, LED luce calda

iron body lamp with dark etched finish, diameter 250 mm, parts in natural brass, electric wire black covered, ceiling base with built-in driver, LED warm light

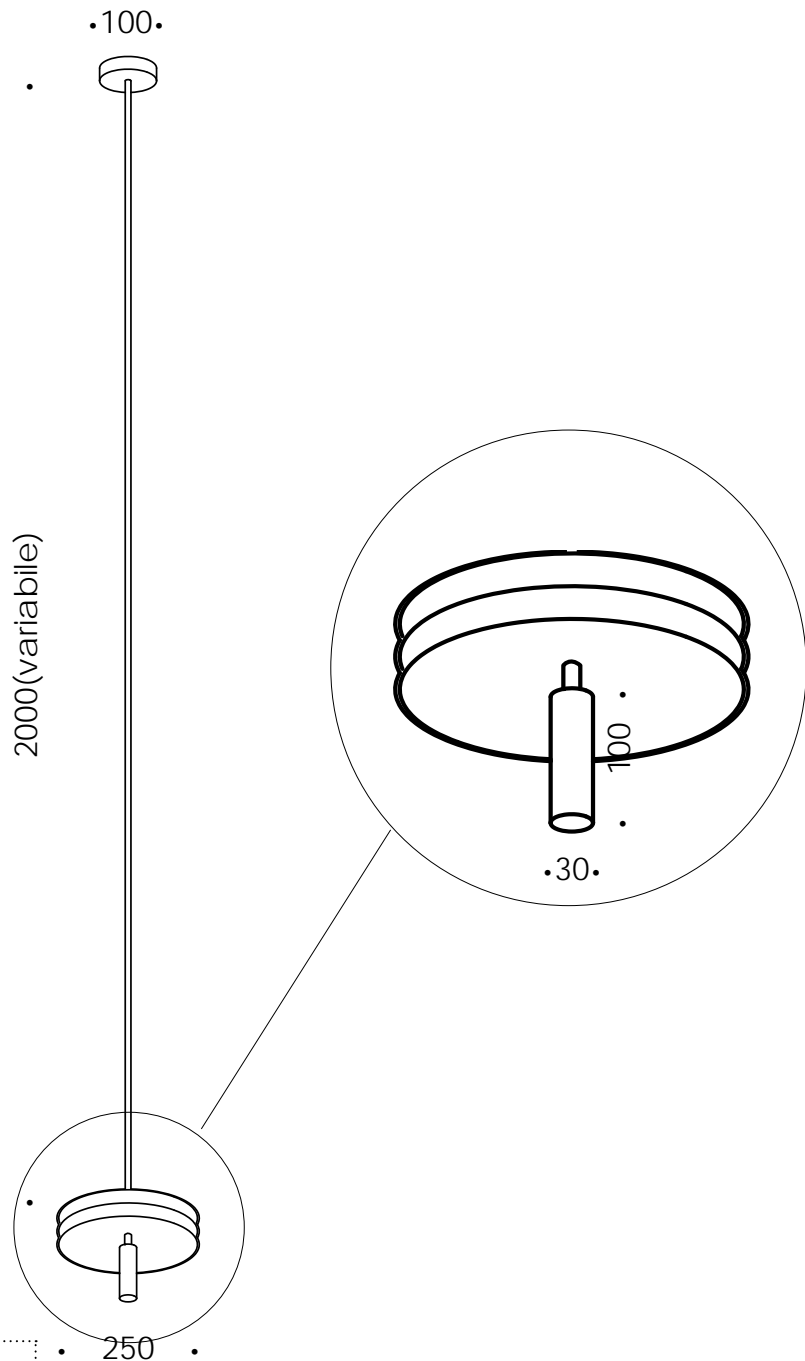

LAMPADA/ATTACCO
LAMP/LAMP HOLDER
LED 3W 350mA 2700K 3W 400Lm

COD. ART.10.003
FINITURA acidatura scura / dark etched
MATERIALE ferro / iron

*LED integrato
*built in LED
Classe Energetica / Energy Label E

Renzo Serafini

DESIGN RENZO SERAFINI

Isolatore 250

ISTRUZIONI DI MONTAGGIO

ASSEMBLY INSTRUCTION

[disattivare l'alimentazione di rete prima di iniziare l'installazione]

[switch off the mains supply before starting the installation]

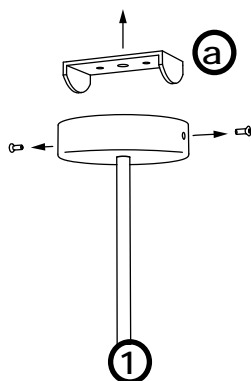

svitare le viti e fissare a soffitto la staffa 'a'
undo the screws and fix 'a' to the ceiling

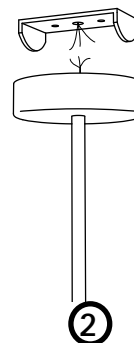

eseguire il cablaggio alimentando con 230V il morsetto L/N in uscita dal driver
do the wiring powering the output terminal driver with 230V

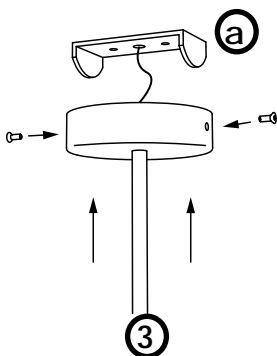

fissare la struttura ad 'a' ed avvitare le viti laterali
fix the structure to 'a' and tighten the side screws

Renzo Serafini

DESIGN RENZO SERAFINI

Isolatore led



IP20



DESCRIZIONE DESCRIPTION

corpo in ferro
corten, diametro
100 mm, particolari
in ottone naturale,
cavo alimentazione
in tessuto cotone,
**basetta di fissaggio
con driver incluso, LED
luce calda**
iron body lamp with
corten finish, diameter
100 mm, parts in
natural brass, electric
wire black covered,
ceiling base with built
in driver, LED warm
light

LAMPADA/ATTACCO
LAMP/LAMP HOLDER

LED 2W 350mA 2700K 190Lm

*LED integrato
*built in LED

Classe Energetica / Energy Label **F**

Renzo Serafini

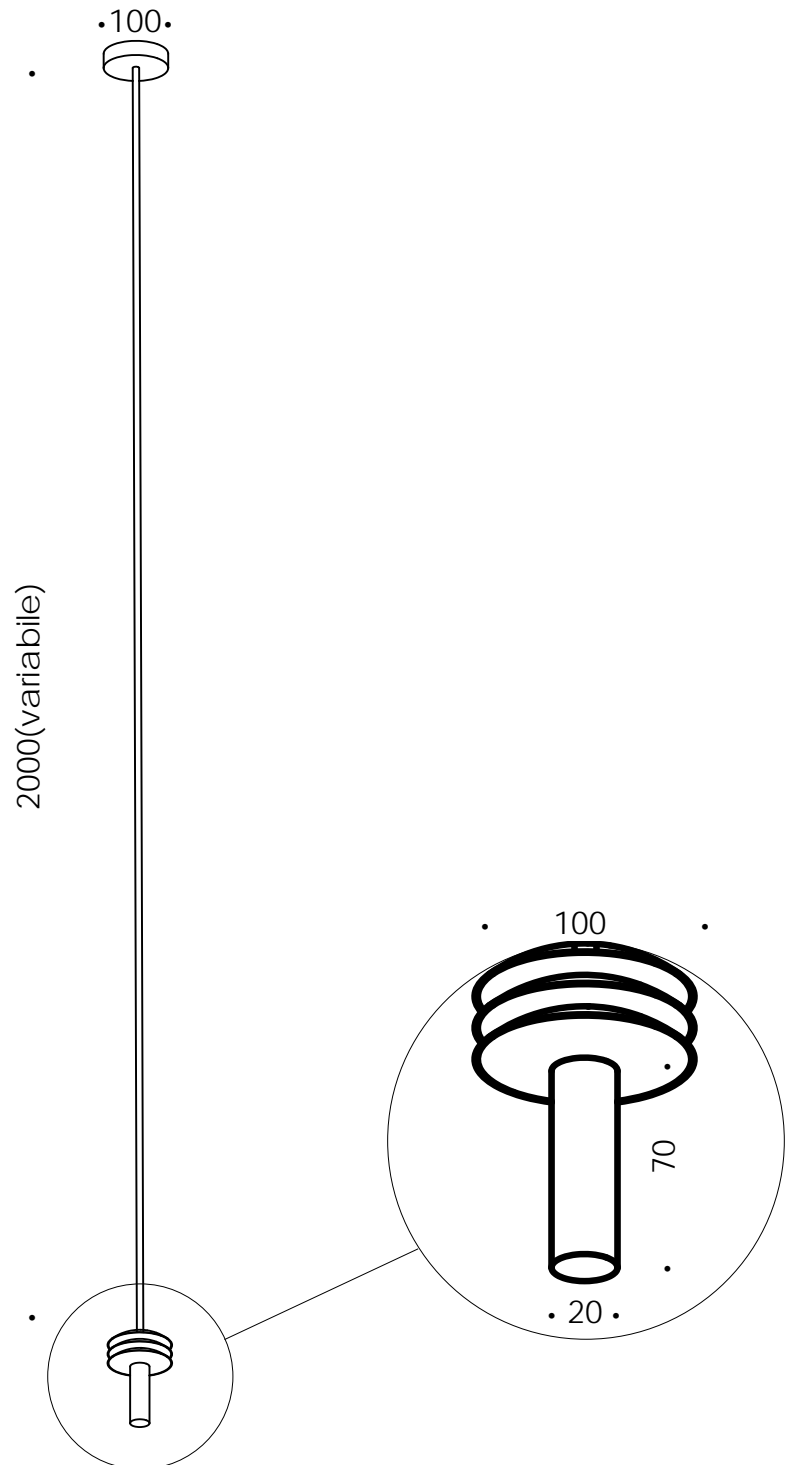

COD. ART.10.013
FINITURA corten / corten
MATERIALE ferro / iron

DESIGN RENZO SERAFINI

Isolatore led

ISTRUZIONI DI MONTAGGIO

ASSEMBLY INSTRUCTION

[disattivare l'alimentazione di rete prima di iniziare l'installazione]

[switch off the mains supply before starting the installation]

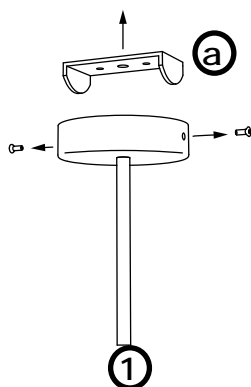

svitare le viti e fissare a soffitto la staffa 'a'
undo the screws and fix 'a' to the ceiling

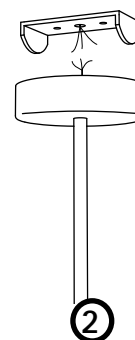

eseguire il cablaggio alimentando con 230V il morsetto L/N in uscita dal driver
do the wiring powering the output terminal driver with 230V

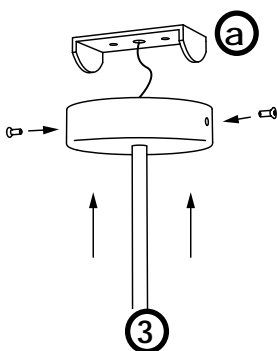

fissare la struttura ad 'a' ed avvitare le viti laterali
fix the structure to 'a' and tighten the side screws

Renzo Serafini