

DESIGN RENZO SERAFINI

Imbuto
chandelier



IP20



DESCRIZIONE DESCRIPTION

corpo in ferro, 8
cappelli in alluminio
orientabili, acidatura
scura con interno oro
bruciato
iron, 8 adjustable
aluminium hats,
external dark etching
finish, internal
burnished finish

**LAMPADA/ ATTACCO
LAMP/ LAMP HOLDER**

GU10 230V

*lampadina non inclusa
*bulb not included

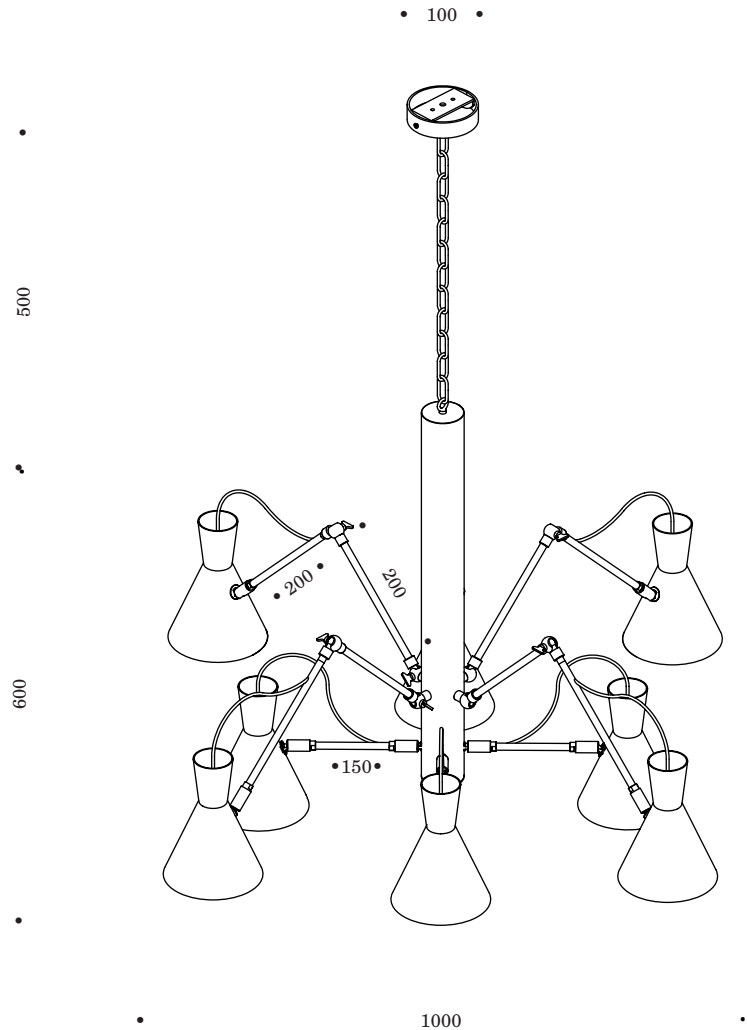

COD. ART10.027

FINIURA acidatura scura / dark etched

MATERIALE ferro, alluminio / iron, aluminium

Renzo Serafini

DESIGN RENZO SERAFINI

Imbuto chandelier

ISTRUZIONI DI MONTAGGIO ASSEMBLY INSTRUCTION

[disattivare l'alimentazione di rete prima di iniziare l'installazione]
[switch off the mains supply before starting the installation]

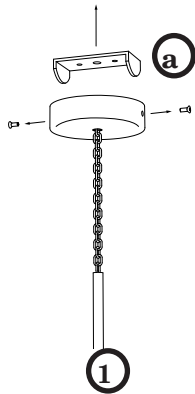

svitare le viti e fissare a soffitto la staffa 'a'
undo the screws and fix 'a' to the ceiling

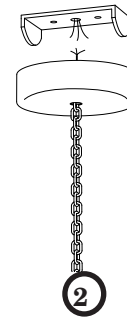

eseguire il cablaggio con alimentazione 230V.
Collegare cavo giallo/verde di messa a terra.
do the wiring with 230V power supply.
Connect the yellow/green ground wire

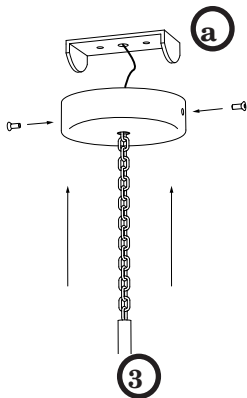

fissare la struttura ad 'a' ed avvitare le viti laterali
fix the structure to 'a' and tighten the side screws

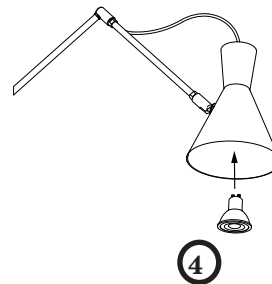

inserire le lampadine ai portalampada GU10
insert the bulbs to the GU10 lamp holders

Renzo Serafini

DESIGN **RENZO SERAFINI**



DESCRIZIONE DESCRIPTION

corpo in ottone naturale, 4 cappelli in alluminio verniciati rame brunito con interno oro aranciato

natural brass, 4 burnished copper painted aluminium hats with orange gold inside

LAMPADA/ ATTACCO
LAMP/ LAMP HOLDER

 GU10 230V

***lampadina non inclusa**

***bulb not included**

**Barra
imbuto 4x**

SO SPESE PENDANT

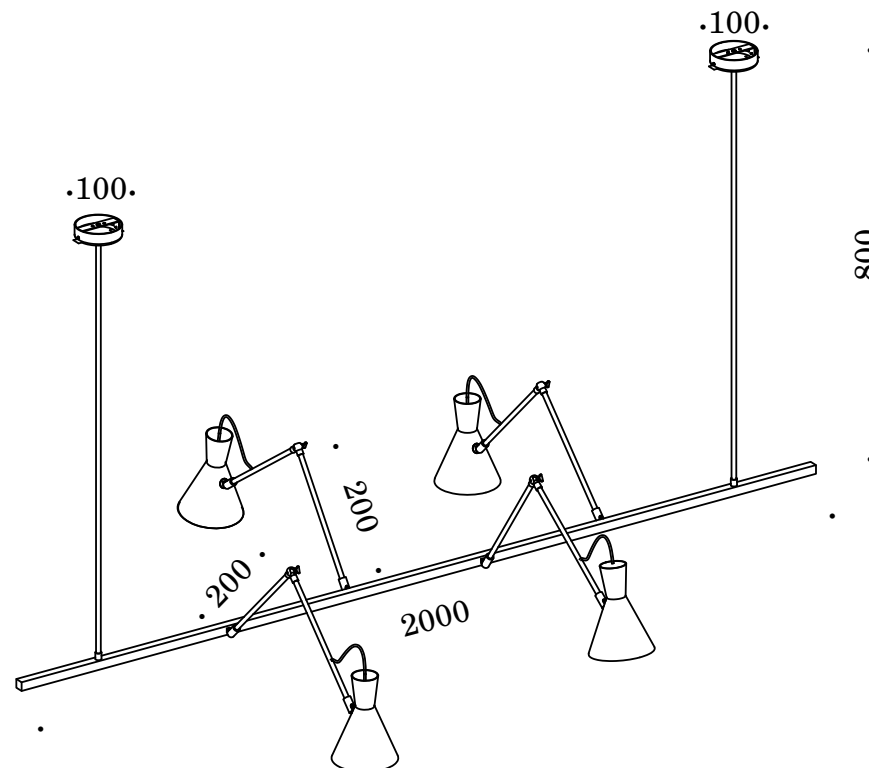

COD. ART10.028

FINIURA ottone spazzolato/ brushed brass

MATERIALE ottone, alluminio / brass, aluminium

Barra imbuto 4x

DESIGN RENZO SERAFINI

ISTRUZIONI DI MONTAGGIO ASSEMBLY INSTRUCTION

[disattivare l'alimentazione di rete prima di iniziare l'installazione]

[switch off the mains supply before starting the installation]

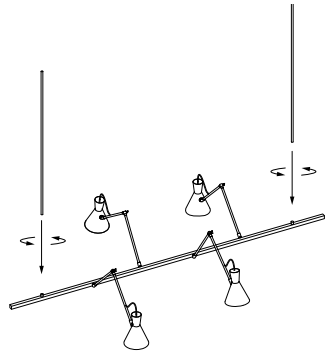

- 1** avvitare i tubolari tondi verticali in posizione perpendicolare alla barra orizzontale con punti luce
screw the vertical round tubulars perpendicular to the horizontal bar with light points

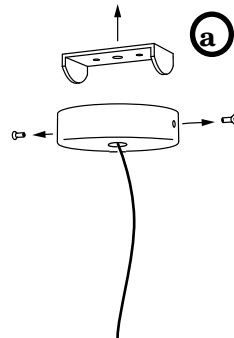

- 2** svitare le viti e fissare a soffitto la staffa 'a'
undo the screws and fix 'a' to the ceiling

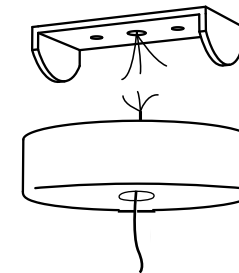

- 3** eseguire il cablaggio con alimentazione 230V.
Collegare cavo giallo/verde di messa a terra
do the wiring with 230V power supply.
Connect the yellow/green ground wire

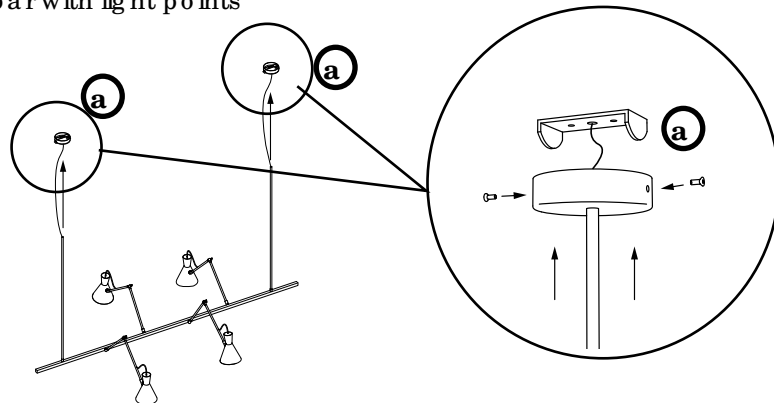

- 4** fissare a soffitto le basi alle staffe 'a' precedentemente montate e fissare la struttura alle basi
fix the bases to the previously mounted 'a' brackets on the ceiling and fix the structure to the bases